

QT11-W Wireless Universal Transmitter Sensor

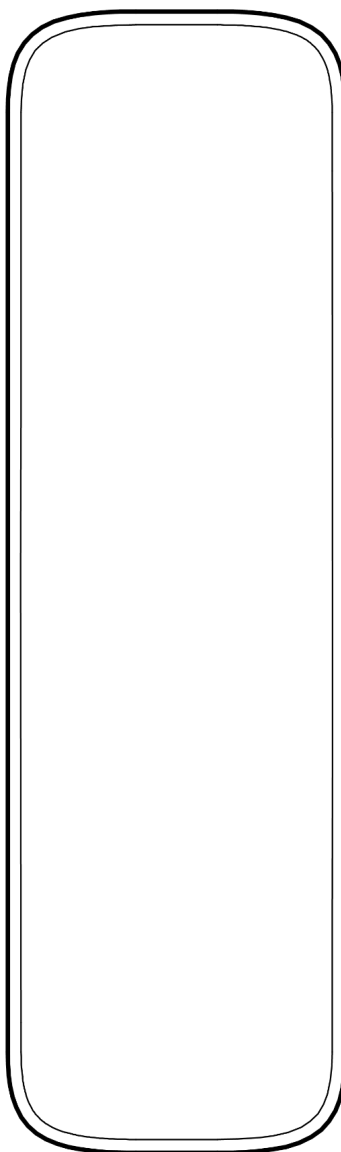

Document Details

Version

V1.0 20250919

(V1.0 published 20250919)

Firmware

Firmware version can be verified on Verkada

Command command.verkada.com.

Product Models

This install guide pertains to model QTII-W-HW.

© Copyright 2025 Verkada Inc. All rights reserved.

Verkada and the Verkada logo are registered trademarks or service marks of Verkada Inc. ("Verkada"). All other trademarks are the property of their respective owners.

Verkada may make changes to this document at any time without notice. The information presented herein may be inaccurate or outdated, and Verkada is under no obligation to maintain it. ALL INFORMATION IS PROVIDED "AS-IS" AND WITHOUT ANY WARRANTIES, IMPLIED, EXPRESS, OR OTHERWISE. VERKADA DISCLAIMS LIABILITY FOR ALL DAMAGES, INCLUDING WITHOUT LIMITATION ANY DIRECT, INDIRECT, SPECIAL, INCIDENTAL, PUNITIVE, OR CONSEQUENTIAL DAMAGES, ARISING OUT OF USE OF THIS DOCUMENT.

Any intellectual property rights relating to Verkada products are and shall remain Verkada's exclusive property. Use of any Verkada product is subject to Verkada's end user agreement or other executed agreement with Verkada. No license, either expressed or implied, to use or distribute any Verkada product is granted under this document.

This document may not be sold, resold, licensed or sublicensed and may not be transferred without Verkada's prior written consent. No part of this document may be reproduced in whole or in part without the express written consent of Verkada.



What's in the Box

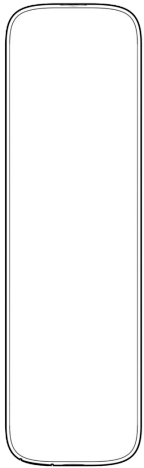

Transmitter Module



Transmitter Mount Plate
(Attached to Transmitter)

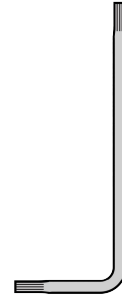

**T10 Security
Torx L-key**

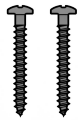

**Wood Screws (2
pcs)**



**Sheet Metal Screws
(2 pcs)**

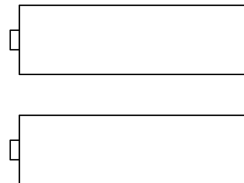

**L91 AA Batteries
(2 pcs)**

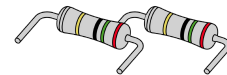

**1kΩ EOL
Supervision Resistors
(2 pcs)**

What you'll need

- Verkada VLink Hub
- A smartphone or laptop
- A working internet connection
- 1/8 inch (3.2mm) drill bit for pilot holes
- #2 Phillips head screwdriver/driver bit
- Wire stripper (for terminal block)
- Flat head screwdriver (for terminal block)
- Two L91 AA Batteries (included)

Connect

For easy registration and setup, scan the QR code on the product.

If you prefer to manually register your product, please proceed to:

verkada.com/start

Overview

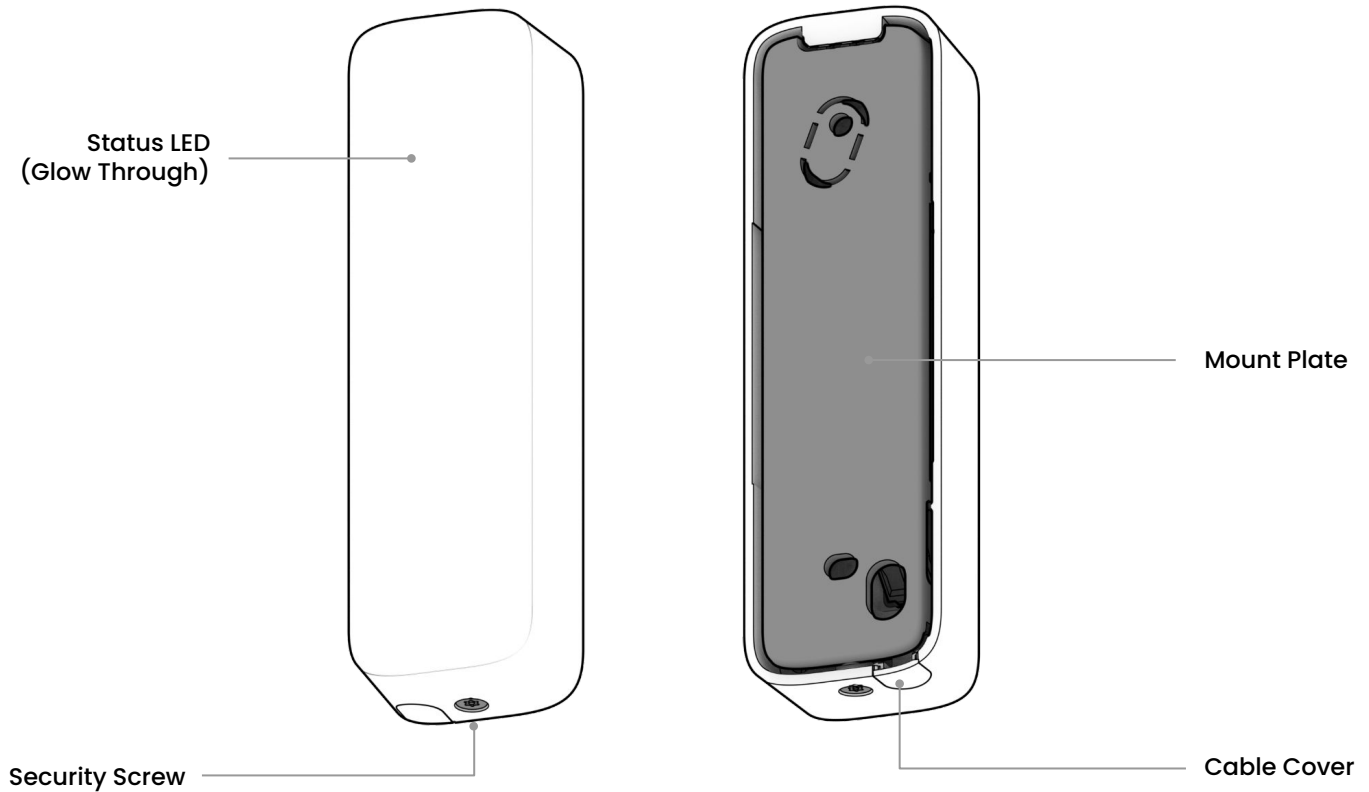

LED Behaviors

Install Mode

To enable Install mode, power cycle the device by removing the battery or enable from Command. The LED will remain active for 5 minutes.

- **Solid Green**
Sensor is detecting a change of state on the input.
- **Blinking Green**
Sensor is searching for a hub to connect to.
- **Blinking Red**
Sensor cannot find a hub to connect to.

Technical Specifications

Battery	2x non-rechargeable Energizer Ultimate Lithium L91 AA batteries (included). <i>*10-year typical battery life.</i>
Connectivity	VLink transceiver with internal antenna (863MHz - 928MHz).
Alarm Input	1x alarm input. Compatible with variable EOL supervision resistors (1k Ω - 4.7k Ω).
RF Range	\geq 2000ft (600m) open field line of sight range when paired with any of Verkada's VLink capable hubs (ex: BP32, BP52, BK22, BE32, WH32, WH52).
Tamper Detection	Yes, breakaway tab.
Dimensions	4.92in (L) x 1.46in (W) x 1.08in (H) / 125mm (L) x 37mm (W) x 27.5mm (H)
Weight	3.5oz / 100g
Operating Temp. & Humidity	32°F-122°F / 0°C-50°C, 0-90% RH non-condensing

Installation

Preparation

Use the provided T10 Security Torx L-key to unscrew the security screw at the bottom of the product.

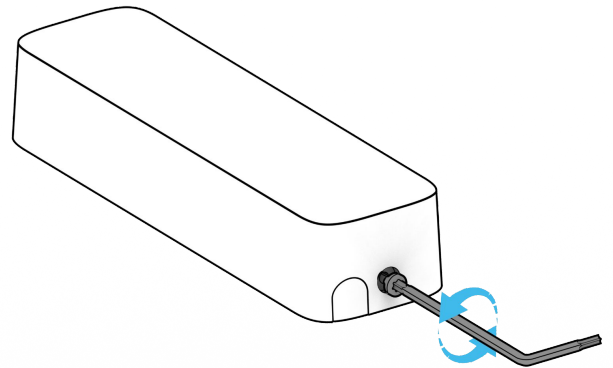

Swing the bottom of the sensor body away from the mount plate and disengage the hook at the top of the sensor mount.

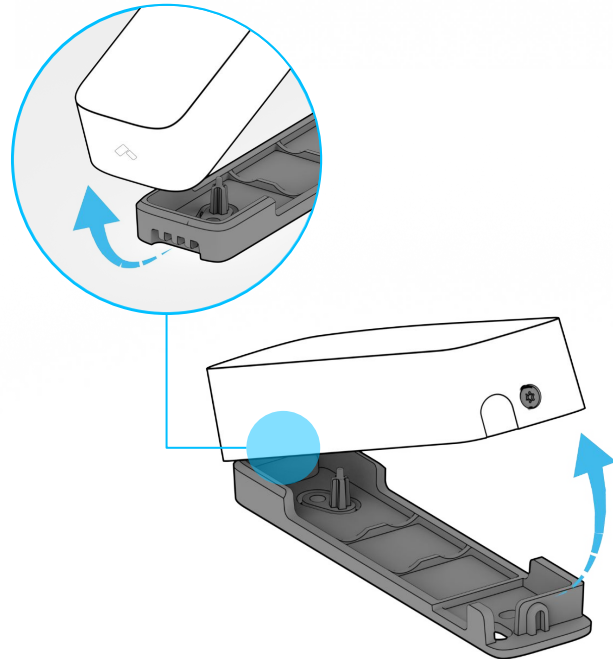

Remove the battery pull tabs.

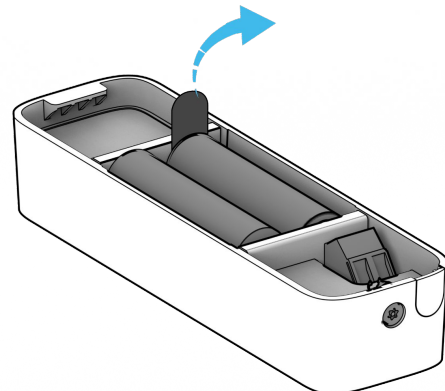

Installation

Mounting 1/2

Use a drill to make pilot holes, and screw the mount plate onto the desired surface.

For routing along the surface, remove the cable exit cover from the sensor cover. For routing through the surface, drill a cutout at the cable exit hole.

Note: Screw mounting is required for the tamper detection to function. Using only adhesive will disable the feature.

Cable Routing Options



Along Surface



Through Surface

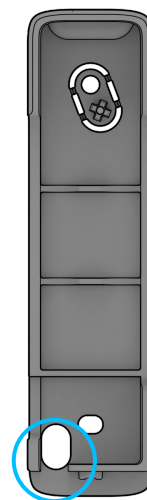
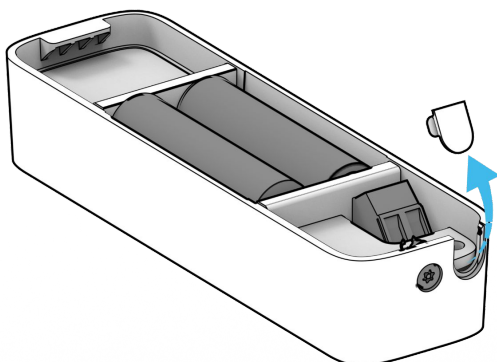

Installation

Mounting 2/2

Connect wires to the terminal block using a flathead screwdriver.

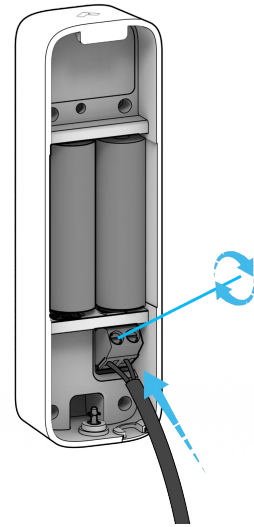

Engage the hook at the top of the sensor mount and swing the sensor module into place.

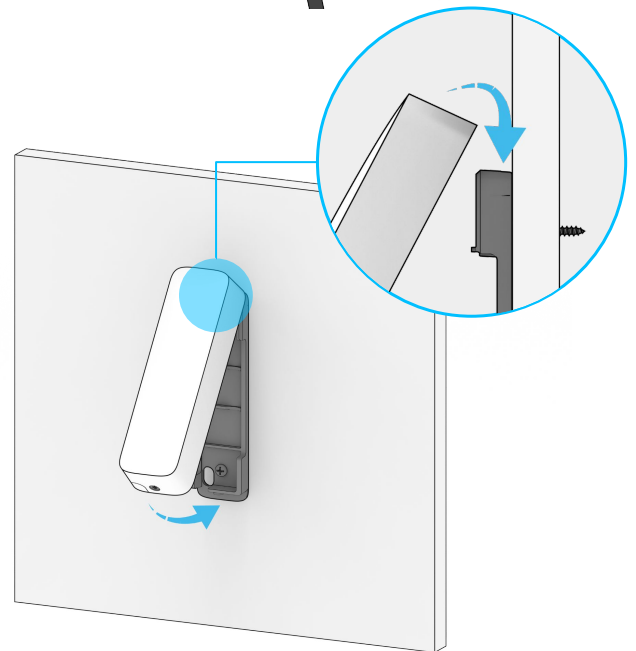

Use the provided T10 Security Torx L-key to secure the security screw in place.

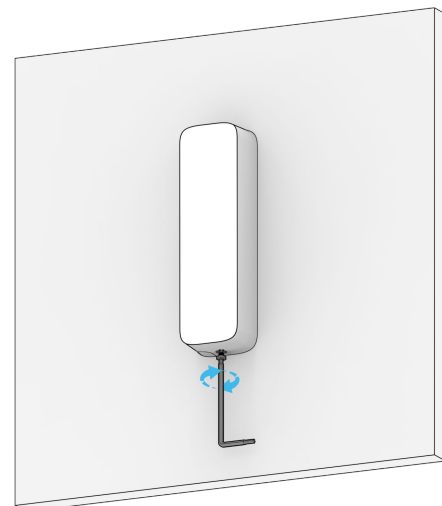

Appendix

Compliance

FCC Compliance

This device complies with part 15 of the FCC Rules. Operation is subject to the following two conditions: (1) This device may not cause harmful interference, and (2) this device must accept any interference received, including interference that may cause undesired operation.

NOTE: This equipment has been tested and found to comply with the limits for a Class B digital device, pursuant to part 15 of the FCC Rules. These limits are designed to provide reasonable protection against harmful interference in a residential installation. This equipment generates, uses and can radiate radio frequency energy and, if not installed and used in accordance with the instructions, may cause harmful interference to radio communications. However, there is no guarantee that interference will not occur in a particular installation. If this equipment does cause harmful interference to radio or television reception, which can be determined by turning the equipment off and on, the user is encouraged to try to correct the interference by one of the following measures:

- Reorient or relocate the receiving antenna.
- Increase the separation between the equipment and receiver.
- Connect the equipment into an outlet on a circuit different from that to which the receiver is connected.
- Consult the dealer or an experienced radio/TV technician for help.

FCC Caution: Any changes or modifications not expressly approved by the party responsible for compliance could void the user's authority to operate this equipment.

FCC Radiation Exposure Statement :

This equipment complies with FCC radiation exposure limits set forth for an uncontrolled environment. This equipment should be installed and operated with minimum distance 40cm between the radiator & your body. Any changes or modifications not expressly approved by the party responsible for compliance could void your authority to operate the equipment.

Professional Installation:

This device must be professionally installed. The intended use is generally not for the general public. It is generally for industrial and commercial use. Installers must be provided with antenna installation instructions and transmitter operating conditions for satisfying RF exposure compliance and other FCC rules.

Appendix

Compliance

ISED Compliance

This device complies with ISED's licence-exempt RSSs. Operation is subject to the following two conditions: (1) This device may not cause harmful interference, and (2) this device must accept any interference received, including interference that may cause undesired operation.

Le présent appareil est conforme aux CNR d'ISED applicables aux appareils radio exempts de licence. L'exploitation est autorisée aux deux conditions suivantes : (1) le dispositif ne doit pas produire de brouillage préjudiciable, et (2) ce dispositif doit accepter tout brouillage reçu, y compris un brouillage susceptible de provoquer un fonctionnement indésirable.

IC Radiation Exposure Statement:

This equipment complies with IC RSS-102 radiation exposure limits set forth for an uncontrolled environment. This equipment should be installed and operated with minimum distance 20cm between the radiator & your body.

Déclaration d'exposition aux rayonnements d'IC : Cet équipement est conforme aux limites d'exposition aux rayonnements IC RSS-102 définies pour un environnement non contrôlé. Cet équipement doit être installé et utilisé avec une distance minimale de 20cm entre le radiateur et votre corps.

Supported Antennas:

This radio transmitter 26271-60B5601 has been approved by Innovation, Science and Economic Development Canada to operate with the antenna types listed below, with the maximum permissible gain indicated. Antenna types not included in this list that have a gain greater than the maximum gain indicated for any type listed are strictly prohibited for use with this device.

Le présent émetteur radio 26271-60B5601 a été approuvé par Innovation, Sciences et Développement économique Canada pour fonctionner avec les types d'antenne énumérés ci-dessous et ayant un gain admissible maximal. Les types d'antenne non inclus dans cette liste, et dont le gain est supérieur au gain maximal indiqué pour tout type figurant sur la liste, sont strictement interdits pour l'exploitation de l'émetteur.

Appendix

Support

Thank you for purchasing this Verkada product. If for any reason you're experiencing issues or need assistance, please contact our 24/7 Technical Support Team immediately.

Sincerely,
The Verkada Team
verkada.com/support

