

COSLUS

C20

Oral Irrigator
User Manual

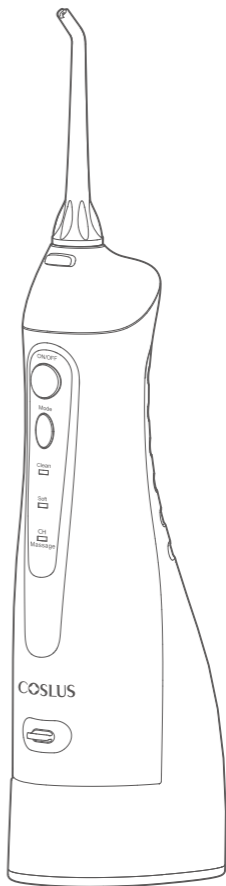



IMPORTANT SAFETY CAUTIONS

All information in this part is provided to instruct you to use the appliance in a correct and safe way so that you can avoid injures to yourself and others as well as damage to property.

- This appliance is not intended for use by persons (including children) with reduced physical, sensory or mental capabilities, or lack of experience and knowledge, unless they have been given supervision or instruction concerning use of the appliance by a person responsible for their safety.
- Children should be supervised to ensure that they do not play with the appliance.
- The appliance is only to be used with the charging cable provided with the appliance and a power adapter that meets the specified requirements.
- Never alter the appliance. Also, do not try to disassemble or repair it.
- The battery must be removed from the appliance before it is scrapped.
- Unplug the appliance from power supply when removing the battery.
- The battery should be disposed of safely.
- Regarding how to remove the battery, please refer to disposal instruction.
- Do not fill the tank with water warmer than 40°C.
- If the external flexible cable or cord is damaged, please ask the manufacturer, service agent or qualified professional person for help to avoid hazard.
- Keep the cable or cord away from heated surfaces.
- Please do not use it if you lost the nozzle.
- Do not submerge the device in water.
- Do not use for any purpose other than oral cleaning.
- Keep nozzle away from small children. The nozzle is small enough to be swallowed and can be lodged in the throat.
- Certain types of mouthwash may damage the appliance by causing the housing or water reservoir to crack. Therefore, do not fill water tank with mouthwash.
- People who is suffering from tooth or gum pain may not be able to use the appliance and should consult their dentist before use.
- Do not press the nozzle too firmly against your teeth or gums, or it may cause injury.
- Oral Irrigator must only be supplied at safety extra low voltage corresponding to the marking on the appliance.

Product specifications

Model	C20 (F5020E)
Charge Input	5V \equiv 2A (Max)
Voltage	3.7V
Power	5W
Battery capacity	1400mAh
Noise	< 72dB
Waterproof rating	IPX7
Water pressure range	40-130PSI (\pm 10PSI)
Storage temperature	0-40°C
Humidity	20%-85%
Atmospheric pressure	70-106kPa
Water tank capacity	300ml

Package list

- 1 Main unit × 1
- 2 Standard jet nozzle × 2
- 3 Orthodontic nozzle × 1
- 4 Periodontal nozzle × 1
- 5 Tongue scraper × 1
- 6 User manual × 1
- 7 USB cable × 1 (adapter is not included)

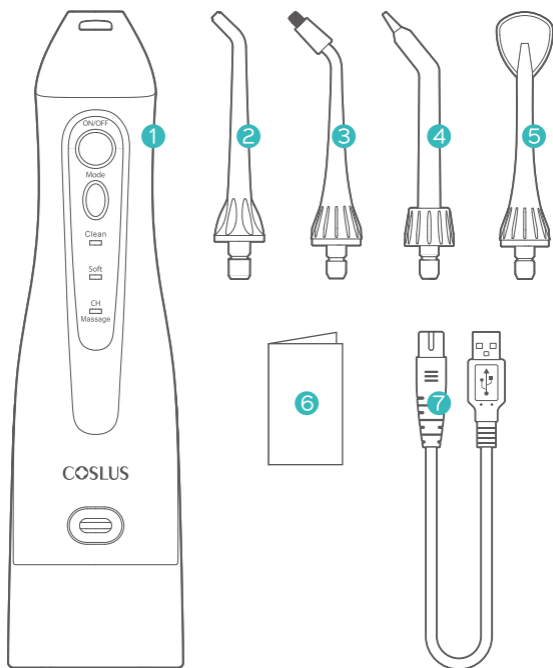

Product overview

- a. Nozzle release button
- b. On/Off button
- c. Mode button
- d. Mode indicator
 - Clean
 - Soft
 - CH
 - Massage
- e. Charging port
- f. Charging port cover
- g. Nozzle
- h. Rotatable ring
- i. Nozzle suction tube
- j. Filter
- k. Water tank
- l. Water tank cap

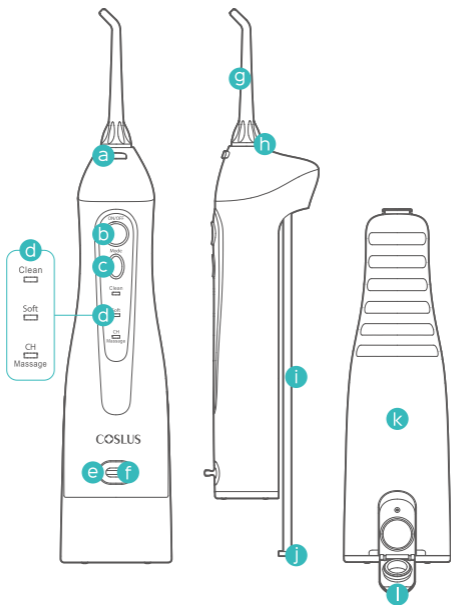

Note: There may be moisture inside the main unit (tank and water suction hose etc.) left from the distilled water used for product testing.

Nozzle introduction

Standard Jet Nozzle: daily clean teeth, gum line, fissure, remove food residue, plaque, etc.



Standard jet nozzle
x 2

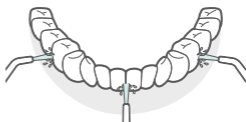

Orthodontic Nozzle: clean bridge and teeth with braces, suitable for those who wear braces or have dental implant.



Orthodontic nozzle
x 1

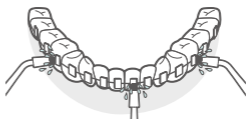

Periodontal Nozzle: clean gingival sulcus, especially suitable for those who are suffering from periodontal diseases. When cleaning periodontal pocket, please use the lowest water pressure. Direct water flow along the gum line with nozzle tip at 45° and turn it on.



Periodontal nozzle
x 1



Tongue Scraper: clean tongue surface, food residue and thick tongue fur. When cleaning tongue, please use the soft mode. Lean forward, put scraper on your tongue and turn it on, then move gently from back to front. You can adjust water pressure according to your need.



Tongue scraper
x 1



Note:

- It is recommended to replace cleaning nozzle every 6 months for better cleaning experience.
- In the same mode, the water pressure of different kinds of nozzles varies. A standard nozzle can offer you the highest water pressure experience.

Use instruction

How to charge

1. Take charging port cover down, securely plug USB cable into charging port of the appliance. (Make sure no liquid remaining inside the port before plugging.)
2. Connect the charging adaptor securely with the power outlet.
3. "CH" indicator blinks during the appliance is charging and it will turn off after it's fully charged.
4. Cover charging port again after charging is finished.

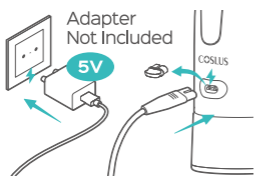

Note: If "CH" indicator blinks during or after an irrigating, that means the battery need to be recharged. One full charging will take about 4 hours.

How to operate

1. Attach nozzle onto the main unit.



2. Open water tank cap to fill the tank with water (not exceed 40°C), then close the cap. Or slide water tank down off the main unit to fill with water (not exceed 40°C), then attach the tank onto the main unit.

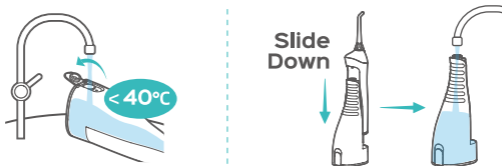

Note: Steps below are very important. Improper operations may cause water leaking or spilling during use.

3. Press “Mode” button to select desired mode. During irrigating, you can change the working mode.

Mode introduction

Clean: Effectively removes debris between teeth.

Soft: For those with sensitive gums.

CH : Softest mode. Suitable for beginners.

Massage: Green indicator. Pulsating water. Effectively removes debris between teeth and massages gums.

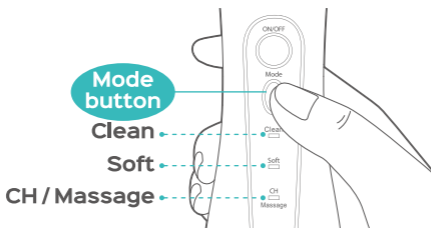

4. Hold the main unit upright with nozzle tip point toward your teeth.
5. Keep your mouth open slightly so that water can flow out.

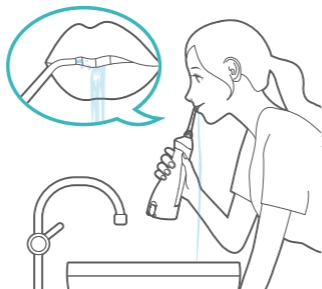

6. Press “On/Off” button to start irrigating.
- 1). Direct water flow at 90° to the teeth and gums
- 2). Direct water flow slowly along the teeth
- 3). Direct water flow along the gum line with nozzle tip at 90°
- 4). Clean between the teeth and around any braces, crowns or bridgework thoroughly

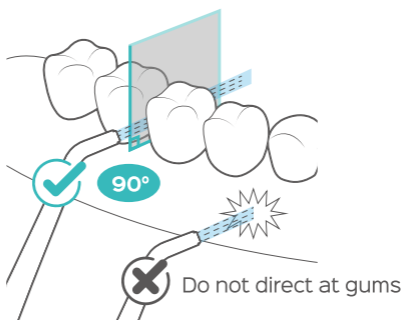

7. After irrigating is finished, press “On/Off” button again to turn off. (Auto shut-off after 2 minutes)



8. Press nozzle release button to remove the nozzle.

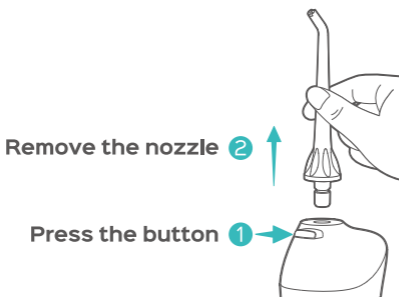

Maintenance instructions

After using

1. Slide the water tank off the main unit, turn it upside down, and empty the water through the top hole. Then attach the tank onto the main unit.
2. Press “On/Off” button to turn on and drain water inside the appliance.
3. Press “On/Off” button again to turn it off.
4. Wipe the appliance with dry cloth.

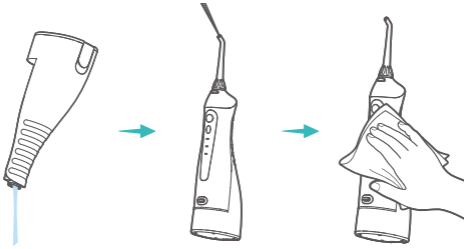

Note: To prevent bacteria breeding, make sure there is no remaining water inside. If you're not going to use the appliance for a long time, be sure to wipe and dry it before storing.

Maintenance

Use only water or neutral cleaning agent to clean the appliance. Never use caustic or abrasive agents (e.g., vinegar or lime scale removers), since they may cause damage to the appliance. Do not use water over 40°C. Keep the appliance away from high temperature and avoid direct sunlight.

● Main unit

1. Wipe the dirt by cloth with soapy water.
2. Do not submerge the main unit in water to clean.
3. Dry after washing with water.

● Water tank cap

Wipe off any grime and dirt with a cloth.

● Nozzle

1. Wash with water and wipe with soft cloth.
2. Replace the nozzle every 6 months.

● Water suction tube

1. Wash with water and wipe with soft cloth.
2. Do not bend, pull or twist the water suction tube.

● Tank

1. Wash with water and wipe with soft cloth.
2. Dry the tank when not using for a long period.

Troubleshooting

Problem	Cause	Solution
Water does not come out	Negative pressure caused by not using for a long time.	Full fill the tank with water, invert the device and shake it to eliminate negative pressure.
		Install the nozzle tip on the main unit, suck out the air from nozzle tip with mouth to eliminate negative pressure.
	You've just purchased the appliance or it has been left unused for a period.	Pull out the nozzle, then flush nozzle hole on the body.
It does not work	You've just purchased the appliance or it has been left unused for more than 3 months.	Charge the appliance for at least 4 hours.
It only works for a few minutes even after charging	The battery has reached the end of its service life.	Contact service center for support.
	Charging time was insufficient.	Charge the unit for at least 4 hours.
Water pressure is very low	There is dirt stuck in the nozzle.	Replace the nozzle.
	The nozzle is deformed.	
	There is dirt stuck in the filter.	Clean the filter.

Disposal / disassembly instructions

The rechargeable battery inside your appliance is easy to remove for recycling. At the end of its service life and prior to disposal, please remove the rechargeable battery following the instructions below.

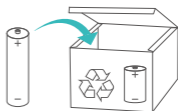

Note: During below operation, be sure to protect your eyes, hands, fingers, and the surface on which you work.

1. Remove 2pcs rubber feet on the bottom of the appliance.
2. Use screwdriver counterclockwise to loosen bottom cap.
3. Slide water tank down off the main unit and unscrew two screws beside nozzle suction tube.

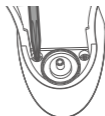
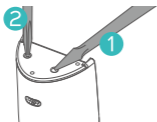

4. Open top cover and put inner part out of the main unit, then unscrew all screws of the inner part.
5. Cut off battery wire and pull out batteries from the inner.

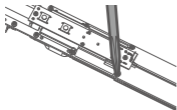

Warm Tip: If you have any question about recycling, please contact your local waste management office.

CONTACT

✉ support@coslus.com  www.coslus.com

☎ +1(855) 594-3950 (9am-5pm Mon. - Fri. (EST))



Intertek
4001301



CONFORMS TO UL
STD. 60335-1&60335-2-52

Made in China